

Black Log Mountain

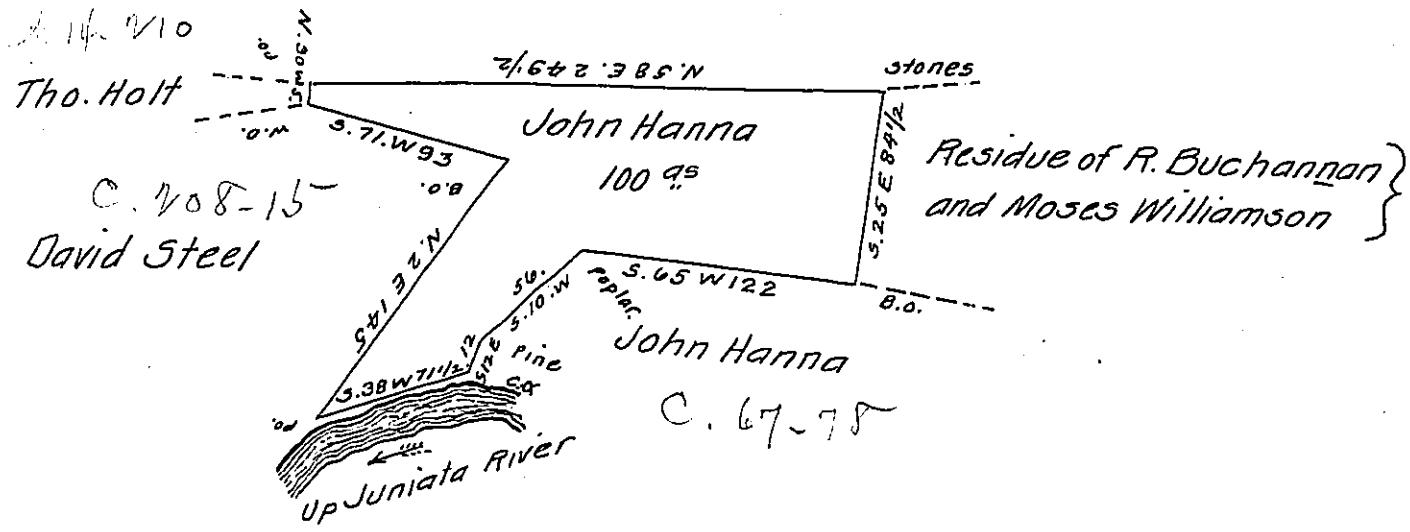

Draught of One hundred Acres with 6 per Cent. Situate in Derry town-
 ship Mifflin County. Survey'd 6th August 1828, in pursuance of an Order
 N^o 964. to John Hanna for 100 ac. dated 26th August 1766.

Examined &c. Novem. 4th 1828.

To Gabriel Hiester Esq^r.
 Surveyor Gen^l of Penna.

J. Mathers D.S.

Note. The above tract is included in a Survey made in pursuance of a
 Warrant to Robert Buchanan and Moses Williamson dated 21st May
 1793. - Unoccupied. Present Owners, Heirs of Robert Buchanan & the
 heirs of William Brown. Esq^r dec^d.

J.M.

R. Buchanan & M. Williamson
 not Returned.

IN TESTIMONY that the above is a copy of the original remaining on file in
 the Department of Internal Affairs of Pennsylvania, made
 conformably to an Act of Assembly approved the 16th day of
 February, 1833, I have hereunto set my Hand and caused
 the Seal of said Department to be affixed at Harrisburg,
 this twenty first day of July 1908.

Henry Howard
 Secretary of Internal Affairs.